

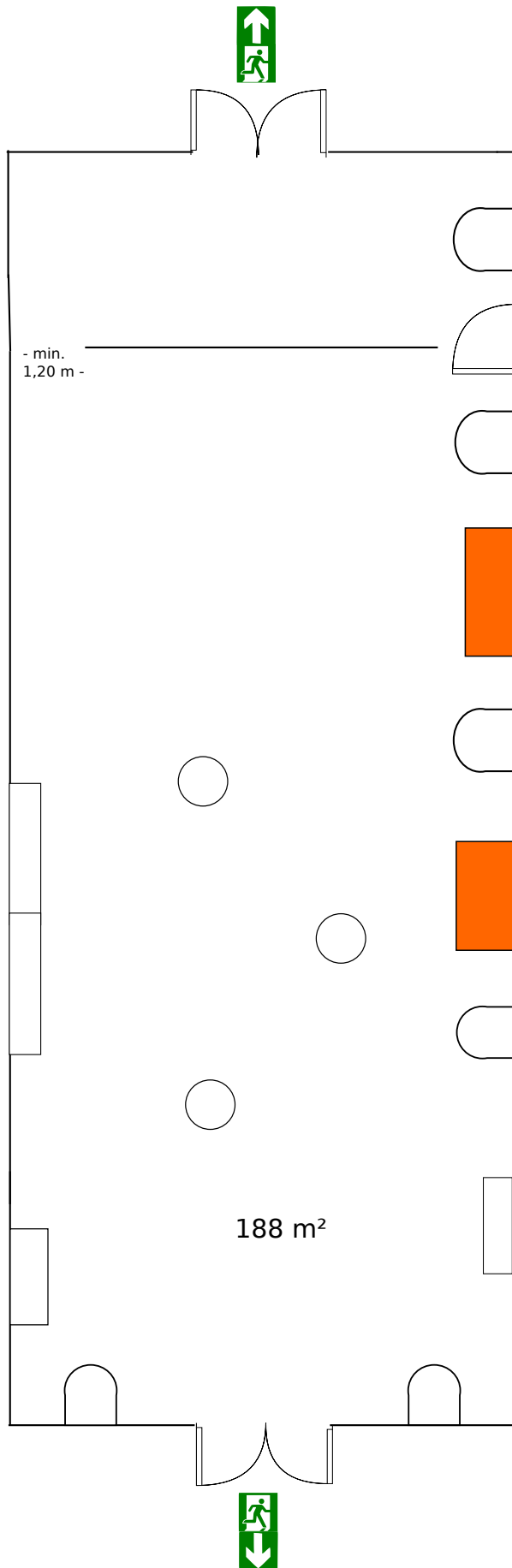



Bestuhlungs- und Rettungswegeplan



Bestuhlungs- variante 5	153 	5 	2 
160 Besucher			

Einstein Kultur Einsteinstr. 42
81675 München

Halle 3 M 1:100

Planersteller: AG Datum Planerstellung: Juli 2014

Genehmigt

____. Fertigung

München, den _____

Branddirektion

Dipl.-Ing. (FH) P. Bachmeier
Branddirektor